

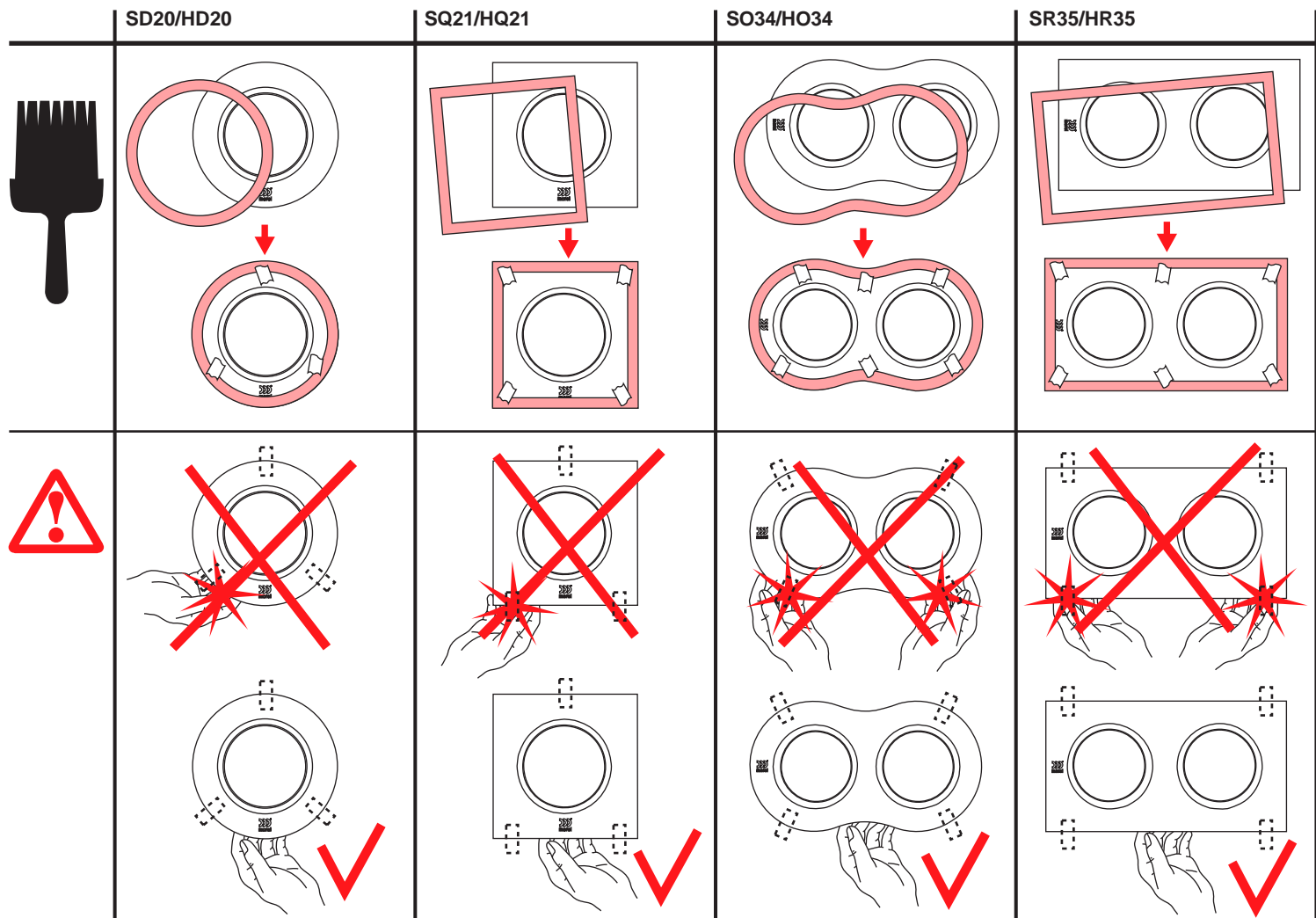

HARMONYtm In Wall, 2-Way Magnetically Shielded Speaker

Installation Instructions

	SD20/HD20	SQ21/HQ21	SO34/HO34	SR35/HR35
1 				
2 				
3				
4				
	5 			



SPECIFICATIONS

SD20/HD20

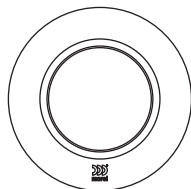

Frame Dimen.: $\varnothing 198 \times 2\text{mm}$ (7 3/4" x 5/64")
 Weight: S - 1.5kg (3.26lb), H - 1.35kg (2.82lb)

SQ21/HQ21

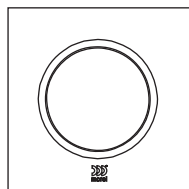

Frame Dimen.: $\blacksquare 198 \times 2\text{mm}$ (■ 7 3/4" x 5/64")
 Weight: S - 1.3kg (2.82lb), H - 1.15kg (2.50lb)

SO34/HO34

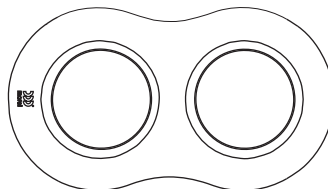

Frame Dimen.: 350 x 198 x 2mm
 (13 3/4" x 7 3/4" x 5/64")
 Weight: S - 2.8kg (6.10lb), H - 2.5kg (5.43lb)

SR35/HR35

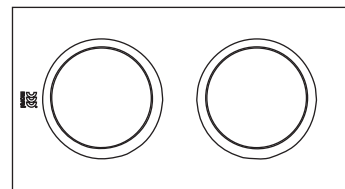

Frame Dimen.: 350 x 198 x 2mm
 (13 3/4" x 7 3/4" x 5/64")
 Weight: S - 2.6kg (5.65lb), H - 2.3kg (5.0lb)

Specifications (per single loudspeaker unit)	S - Type	H - Type
Construction	$\varnothing 130\text{mm}$ (5 1/4") mild steel sphere enclosure.	$\varnothing 130\text{mm}$ (5 1/4") mild steel sphere enclosure.
Mounting depth	90mm (3 1/2").	90mm (3 1/2").
Finish	Epoxy spray, oven-enameled.	Epoxy spray, oven-enameled.
Color Availability	Sanded white. Custom orders available upon request.	Sanded white. Custom orders available upon request.
Drive-units	Woofer - $\varnothing 100\text{mm}$ (4") with $\varnothing 54\text{mm}$ (2 1/8") Aluminum Hexatech Voice-Coil, Neodymium magnet Motor. Tweeter - Acuflex™ coated soft dome, $\varnothing 28\text{mm}$ (1 1/8") liquid cooled, Aluminum Hexatech coil, Neodymium magnet motor.	Woofer - $\varnothing 100\text{mm}$ (4") with $\varnothing 20\text{mm}$ (3/4") High Temperature Voice-Coil, Ferrite magnet Motor. Tweeter - Semi-Soft Polymer $\varnothing 12\text{mm}$ (1/2") liquid cooled Voice-Coil, Neodymium magnet motor.
Nominal Impedance	6 ohm (SO34, SR35 - 8 ohm)	8 ohm
Nominal Power Handling	100W (200W peak)	60 W (100 W peak)
Crossover	6 dB + 12db per octave, 3500Hz	6 dB per octave, 8000Hz
Frequency Response	95-22,000Hz (-5 dB)	100-20,000 Hz (-5 dB)
Sensitivity (2.83V 1M)	86 dB (SO34, SR35 - 84.5 dB)	89 dB

