



A.O. Smith Water Heater Parts Fulfillment
 125 Southeast Parkway • Franklin, TN 37068
 www.hotwater.com • 1-800-433-2545

RESIDENTIAL GAS SERVICE PARTS LIST

MODELS:

GCVL- 40 200/210, XCVL- 40 200/201,	GCV- 40 200/201 XCV- 40 200/201, GCVH- 40L 200/201,	GVR- 40 200/201, XVR- 40 200/201, XGV- 40 200/201,
GVRL- 40 200/201,	GCV- 50 200/201, XCV- 50 200/201,	GVR- 50 200/201, XVR- 50 200/201, XGV- 50 200/201;

Actual water heater may have one of the following SMRs, so it will vary from list accordingly;

- S19 - Magnesium Anode
 - S24 - No Name Plate
 - S41 - KA 90 Anode
 - S45 - Outlet Anode, Top T&P
 - S83 - Outlet Magnesium Anode, Top T&P
 - T25 - Magnesium Anode, Canadian Model
- Circulating Loop model ("L") after capacity same as standard except receive outlet magnesium & primary magnesium anode.

ANODE LOCATION
 OR
 TOP T&P LOCATION

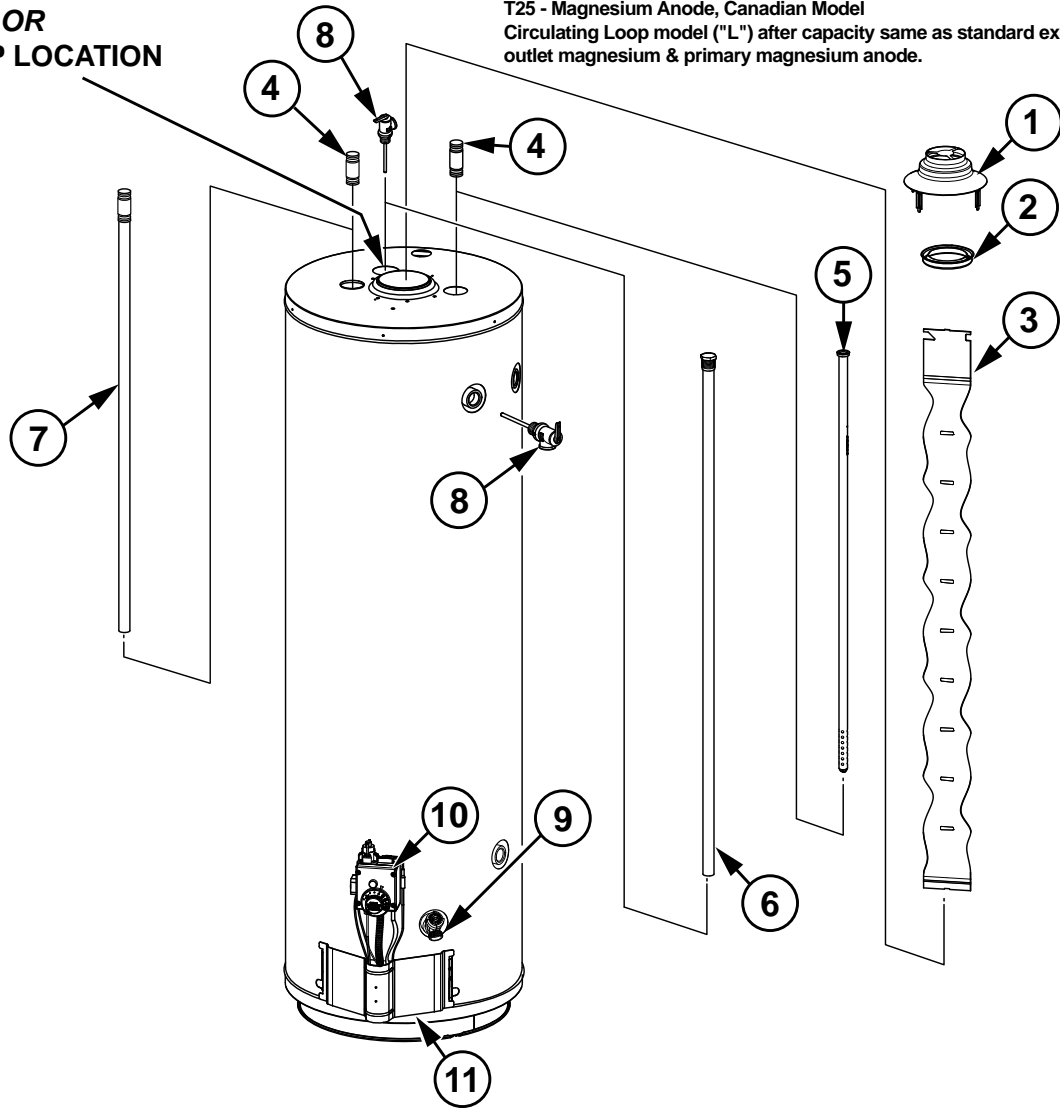

Item	Description	GCVL - 40	GCV - 40	GVR - 40	GVRL - 40	GCV - 50	GVR - 50
		XCVL - 40 200/201	XCV - 40 GCVH - 40L 200/201	XVR - 40 XGV - 40 200/201		XCV - 50 200/201	XVR - 50 XGV - 50 200/201
1	Draft Hood	9006647005	9006647005	9006647005	9006647005	9006647005	9006647005
2	Reducer Ring (some models)	9000275015	9000275015	9000275015	9000275015	9000275015	9000275015
3	Flue Baffles (Natural Gas)	9006662005	9006664005	9006664005	9006662005	9006623005	9006623005
	Flue Baffles (L.P. Gas)	9006663005	9006669005	9006669005	9006663005	9006623005	9006623005
4	Heat Trap Nipple	9003719015	9003719015	9003719015	9003719015	9003719015	9003719015
5	Inlet Tube	9006689005	9006690005	9006690005	9006689005	9006688005	9006688005
	Inlet Tube Dynaclean II - XGV Models	NA	NA	9003473005	NA	NA	9006653005
6	Anode Aluminum	9003892005	9003892005	9003892005	9003892005	9003892005	9003892005
	Anode Magnesium	9001829005	9001829005	9001829005	9001829005	9001829005	9001829005
	Anode KA90	9006299005	9006299005	9006299005	9006299005	9006299005	9006299005
7	Outlet Anode (Alum.) W/Heat Trap	9006291005	9006291005	9006291005	9006291005	9006291005	9006291005
	Outlet Anode (Mag.) W/Heat Trap	9003938005	9003938005	9003938005	9003938005	9003938005	9003938005
	Anode Rod (GCVH-40L model only)	NA	9003934005	NA	NA	NA	NA
8	T&P Valve (top or side)	9000071015	9000071015	9000728015	9000728015	9000071015	9000728015
9	Drain Valve	9004330015	9004330015	9001870015	9001870015	9004330015	9001870015
10	Gas Control Valve/Thermostat (w/lead wires) (Natural)	9006655005	9006655005	9006656005	9006656005	9006655005	9006656005
	Gas Control Valve/Thermostat (w/lead wires) (L.P)	9006657005	9006657005	9006658005	9006658005	9006657005	9006658005
11	Outer Door	9006648005	9006648005	9006648005	9006648005	9006648005	9006648005
	Outer Door (XGV models only)	NA	NA	9006649005	NA	NA	9006649005
12*	Pilot Assembly Kit (Natural Gas)	9006666015	9006666015	9006666015	9006666015	9006666015	9006666015
	Pilot Assembly Kit (L.P. Gas)	9006668015	9006667015	9006667015	9006668015	9006667015	9006667015
13*	Burner (Natural Gas/Low Nox)	9006136005	9006136005	9006136005	9006136005	9006136005	9006136005
	Burner (L.P. Gas/Low Nox)	9006651005	9006603005	9006603005	9006651005	9006603005	9006603005
14*	Complete Burner/Door Assembly (Natural Gas)	9006619005	9006620005	9006620005	9006619005	9006621005	9006621005
	Complete Burner/Door Assembly (L.P. Gas)	9006691005	9006618005	9006618005	9006691005	9006622005	9006622005
15*	Two Piece Wire Connector w/Retainer Clip	9006449015	9006449015	9006449015	9006449015	9006449015	9006449015
16*	Manifold Door Gasket	9006141015	9006141015	9006141015	9006141015	9006141015	9006141015
17*	Piezoelectric Igniter Button	9003410015	9003410015	9003410015	9003410015	9003410015	9003410015
18*	Thermocouple	9000056015	9000056015	9000056015	9000056015	9000056015	9000056015
19*	Intake Screen	9006660005	9006616005	9006616005	9006660005	9006660005	9006660005
20*	Gasket - For Inlet Tube	9002277015	9002277015	9002277015	9002277015	9002277015	9002277015

* Not shown in illustration.

